



BURLINGTON HOTEL & CONFERENCE CENTRE

3063 South Service Road
Burlington, ON
Canada
L7N 3E9

Tel: (905) 639-4443
Toll Free: 1-888-987-4888
Fax: (905) 333-4033



Accommodations

- 237 well appointed Guest Rooms & 3 Suites
- All Standard & Executive Guest Rooms feature; free wireless internet service, NEW 32" flat screen TV, fridge, windows that open, heated bathroom floors, free weekday newspaper and Bath & Body amenities. (Microwaves in all standard rooms.)
- King Executive Guest Rooms are located on private access club floors and feature; king bed, upgraded amenities, cotton robe to enjoy during your stay, free local calls & bottled water

Attractions

- Variety of Restaurants within walking distance
- Burlington Shopping Mall - over 100 Shops (walking distance)
- Mapleview Shopping Mall - over 200 Shops (10 min. drive)
- Downtown Burlington, one of a kind Shops, The Waterfront Trail, Spencer Smith Park & Lake Ontario (10 min. drive)
- Royal Botanical Gardens (15min. drive)
- IKEA Home Furnishings (10min. drive)

Locations

- Conveniently situated just off the QEW at Guelph Line (Exit 102)
- Ample free parking

Meeting/Banquet Facilities

- Largest Hotel & Conference Centre "Under One Roof" Between Toronto & Niagara Falls
- **NEWLY** renovated Ballrooms
- Over 20,000 square feet of flexible meeting space divides into 22 individual rooms, Halton Hall has drive-in capability
- Meetings, Banquets and Receptions up to 700 people
- Free wireless internet service
- Executive boardrooms

Dining

- **NEW** Alloro Restaurant
- **NEW** Alloro Bar
- Room Service - 7:00 am - 10:00 pm
- **Pizza Hut, EXPRESS** (on-site)

Services/Amenities

- Free 24hr Business Centre
- Gift shop / ATM
- Same day laundry & dry cleaning (Monday to Friday)
- U.S. Currency exchange
- Multilingual staff

Leisure Facilities

- **Holidome/Atrium:** largest heated indoor hotel pool in the city, sauna, whirlpool, fitness centre, ping-pong, billiards & games. Outdoor tennis and basketball court (seasonal)

ROOM	# OF SECTIONS	DIMENSIONS	SQ. FEET	HEIGHT	THEATRE	CLASSROOM	BOARDROOM	U-SHAPE	HOLLOW SQUARE	DINNER/DANCE	BANQUET (ROUNDS OF 8)	BANQUET (ROUNDS OF 10)	RECEPTION	10 x 10 BOOTH
Halton	1	26 x 55	1430	12'	100	70	34	40	40	60	72	90	100	8
	2	52 x 55	2860	12'	250	150	-	-	-	160	144	180	250	16
	3	78 x 55	4290	12'	400	230	-	-	-	240	224	280	350	24
	4	104 x 55	5720	12'	550	300	-	-	-	320	380	420	700	32
Harvester	1	39 x 46	1794	10'	160	100	40	35	40	80	96	120	100	8
	2	78 x 46	3588	10'	350	220	-	-	-	192	192	240	200	16
Burlington	1	24 x 27	648	10'	40	28	20	14	24	-	32	40	50	4
	2	48 x 27	1296	10'	90	56	40	28	35	40	64	80	75	8
	3	72 x 27	1944	10'	140	80	-	-	-	80	96	120	125	12
Pearson		44 x 22	968	10'	60	30	26	25	25	48	64	80	50	4
Holidome		40 x 40	1600	24'	-	-	-	-	-	-	120	150	300	15
Niagara		25 x 27	675	7'6"	44	32	24	20	24	-	32	40	40	
Brant		25 x 27	675	7'6"	44	32	24	20	24	-	32	40	40	
Glenwood		25 x 20	500	7'6"	30	21	20	16	-	-	-	-	-	
LaSalle		25 x 20	500	7'6"	30	21	20	16	-	-	-	-	-	
Ascot		19 x 24	465	6'6"	-	-	10	-	-	-	-	-	-	
Nelson		16 x 24	392	6'6"	-	-	12	-	-	-	-	-	-	
Brock		19 x 11	218	6'6"	-	-	6	-	-	-	-	-	-	
Cartier		16 x 11	184	6'6"	-	-	6	-	-	-	-	-	-	
Cabinet		15 x 27	405	10'	-	-	10	-	-	-	-	-	-	

*Floor plans to scale are available upon request



BURLINGTON HOTEL & CONFERENCE CENTRE

www.hiburlington.ca

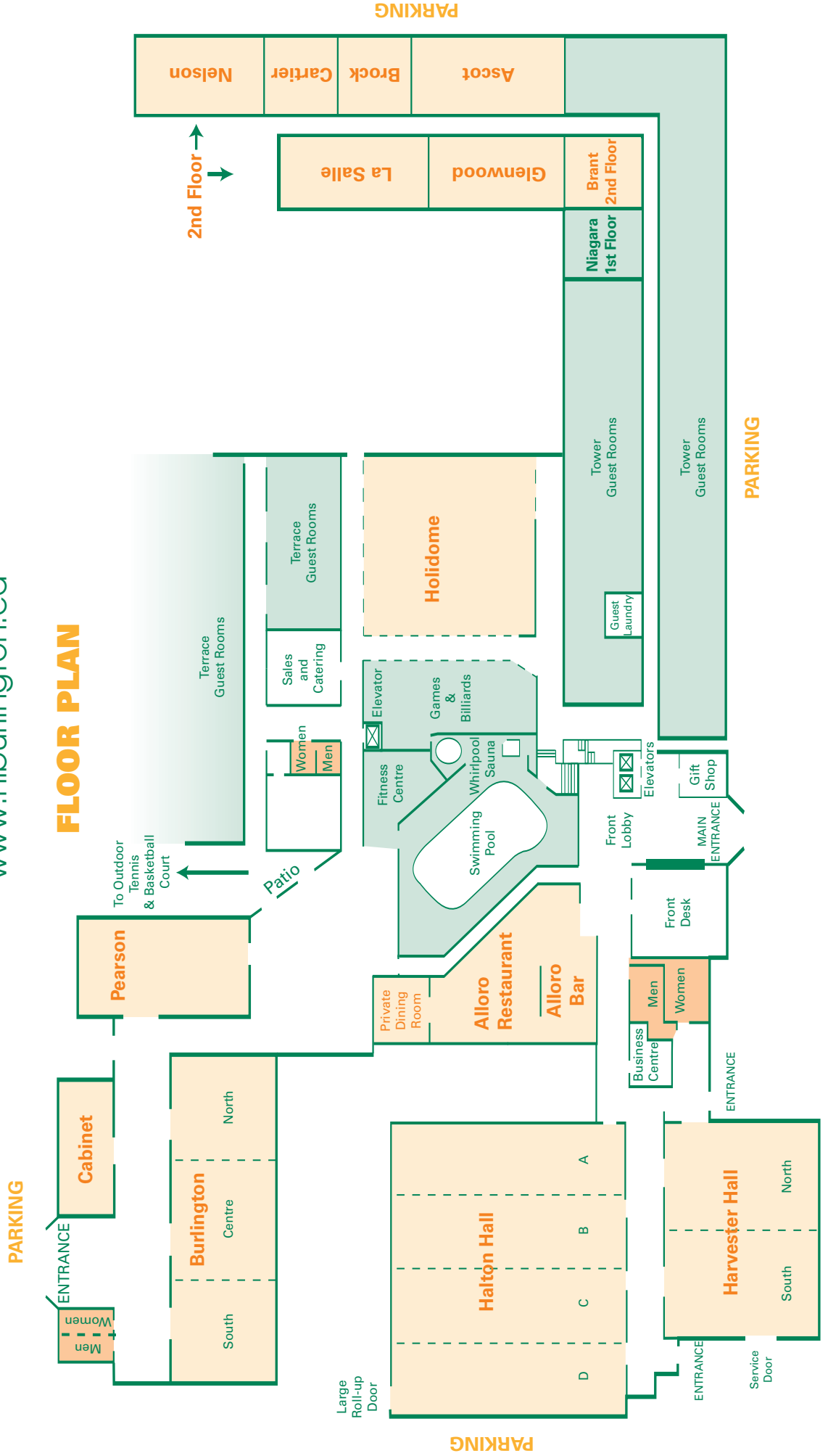

*Floor plan not to scale

See reverse side for dimensions